

Double pitch chain (ISO1275/ANSI B29.3)

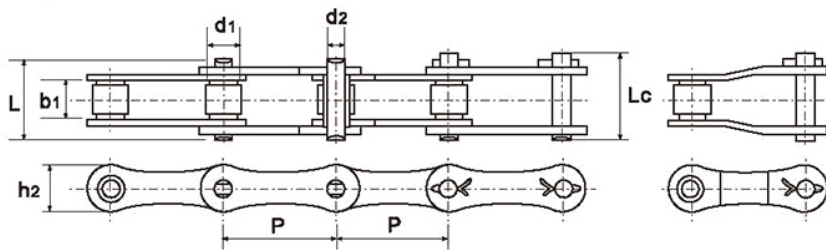

ISO Chain No.	ANSI Chain No.	P	d1	b1	d2	L	Lc	h2	U.T. S. (KN)	Wt. (Kg/m)
208A	A2040	25.40	7.95	7.85	3.96	16.60	18.20	12.07	13.80	0.42
208B		25.40	8.51	7.75	4.45	16.70	18.30	11.81	17.80	0.45
210A	A2050	31.75	10.16	9.40	5.08	20.70	22.10	15.06	21.80	0.73
210B		31.75	10.16	9.65	5.08	19.50	20.90	14.70	22.20	0.63
212A	A2060	38.10	11.91	12.57	5.94	25.20	27.40	18.08	31.10	1.02
212B		38.10	12.07	11.68	5.72	22.40	24.20	16.00	28.90	0.76
216A	A2080	50.80	15.88	15.75	7.92	32.60	38.90	24.00	55.60	1.70
216B		50.80	15.88	17.02	8.28	35.50	39.10	21.00	60.00	1.75
220A	A2100	63.50	19.05	18.90	9.53	40.00	47.20	30.18	86.70	2.55
220B		63.50	19.05	19.56	10.19	41.40	45.00	26.40	95.00	2.62
224A	A2120	76.20	22.23	25.22	11.10	50.30	54.30	35.70	127.00	4.06
224B		76.20	25.40	25.40	14.63	53.40	57.80	33.20	160.00	4.70

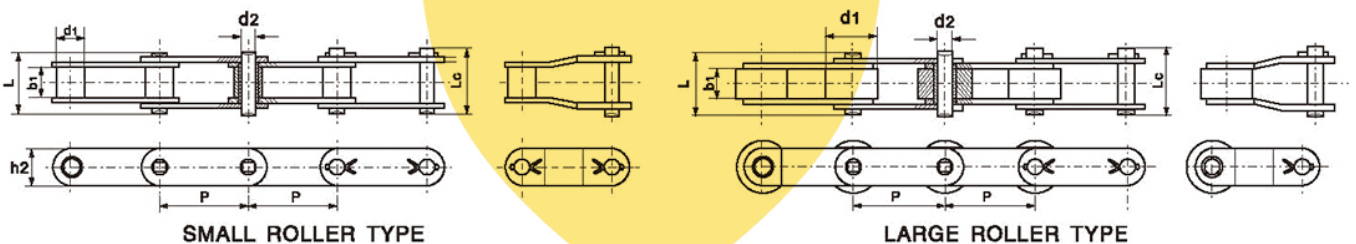

SMALL ROLLER TYPE

LARGE ROLLER TYPE

ISO Chain No.	ANSI Chain No.	P	d1	b1	d2	L	Lc	h2	U.T. S. (KN)	Wt. (Kg/m)
C208A	C2040	25.40	7.95	7.85	3.96	21.70	17.80	12.07	13.80	0.50
C208AL	C2042		15.88							0.84
C208B		25.40	8.51	7.75	4.45	20.09	17.00	11.81	17.80	0.55
C208BL			15.88							0.89
C210A	C2050	31.75	10.16	9.40	5.08	25.90	21.80	15.09	21.80	0.78
C210AL	C2052		19.05							1.27
C212A	C2060	38.10	11.91	12.57	5.94	27.70	25.90	18.00	31.10	1.12
C212AL	C2062		22.23							1.61
C212AH	C2060H	38.10	11.91	12.57	5.94	34.50	29.90	18.08	31.10	1.44
C212AHL	C2062H		22.23							2.07
C216A	C2080	50.80	15.88	15.75	7.92	38.90	33.50	24.13	55.60	2.08
C216AL	C2082		28.58							3.12
C216AHL	C2080H	50.80	15.88	15.75	7.92	39.40	36.20	24.13	55.60	2.54
C216AHL	C2082H		28.58							3.58
C220A	C2100	63.50	19.05	18.90	9.53	47.20	41.40	30.18	86.70	3.01
C220AL	C2102		39.67							4.83
C220AH	C2100H	63.50	19.05	18.90	9.53	50.20	44.10	30.18	86.70	3.60
C220AHL	C2102H		39.67							5.38
C224A	C2120	76.20	22.23	25.22	11.10	54.30	50.40	36.10	124.60	4.66
C224AL	C2122		44.45							7.66
C224AH	C2120H	76.20	22.23	25.22	11.10	57.50	53.50	36.10	124.60	5.26
C224AHL	C2122H		44.45							8.26
C232A	C2160	101.60	28.58	31.75	14.27	69.60	64.80	47.80	226.80	8.15
C232AL	C2162		57.15							13.00
C232AH	C2160H	101.60	28.58	31.75	14.27	73.00	68.20	47.80	226.80	9.06
C232AHL	C2162H		57.15							13.84

Attachments for Double Pitch Chain

A-1

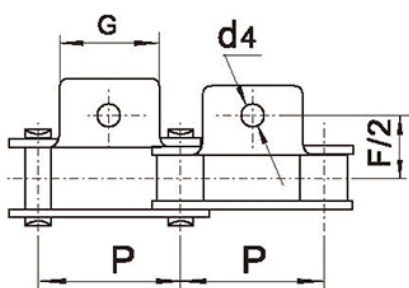

K-1

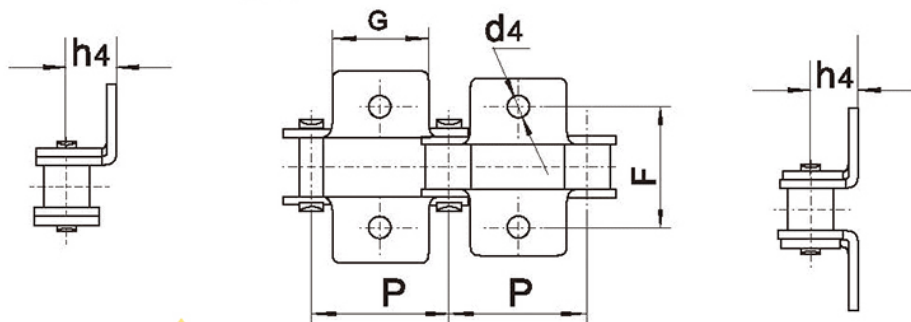

A-2

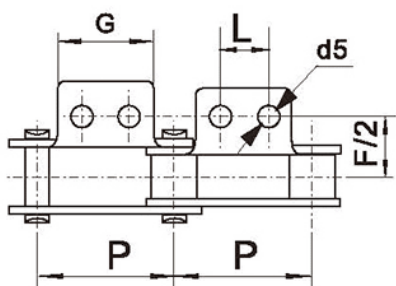

K-2

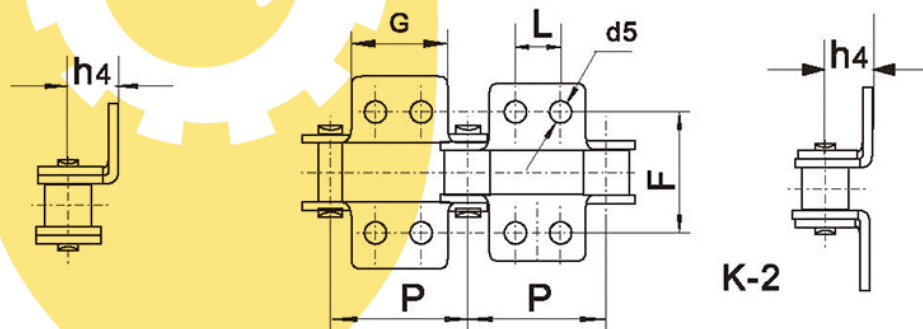

SA-1

SK-1

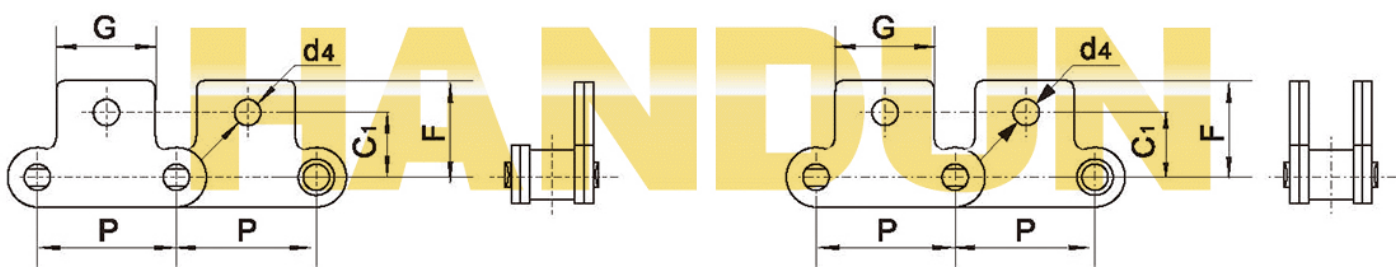

SA-1

SA-2

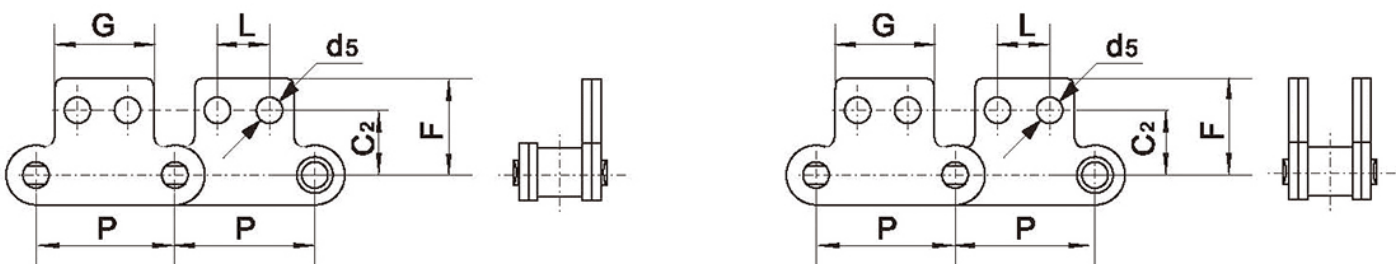

ANSI Chain No.	P	Att. Type	G	L	C1	C2	F	W	h4	d4	d5
C2040/C2042	25.40	A1/K1	19.1	-	-	-	25.4	39.6	9.1	3.4	-
	25.40	A2/K2	19.1	9.5	-	-	25.4	39.6	9.1	3.4	-
	25.40	SA1/SK1	19.1	-	11.1	13.5	20.5	-	-	3.4	5.5
	25.40	SA2/SK2	19.1	9.5	11.1	13.5	20.5	-	-	3.4	5.5
C2050/C2052	31.75	A1/K1	23.8	-	-	-	31.8	49.0	11.1	5.5	-
	31.75	A2/K2	23.8	11.9	-	-	31.8	49.0	11.1	5.5	-
	31.75	SA1/SK1	23.8	-	14.3	15.9	25.0	-	-	5.5	6.6
	31.75	SA2/SK2	23.8	11.9	14.3	15.9	25.0	-	-	5.5	6.6
C2060/C2062	38.10	A1/K1	28.6	-	-	-	42.9	67.8	14.7	5.5	-
	38.10	A2/K2	28.6	14.3	-	-	42.9	67.8	14.7	5.5	-
	38.10	SA1/SK1	28.6	-	17.5	19.1	32.9	-	-	5.5	9.2
	38.10	SA2/SK2	28.6	14.3	17.5	19.1	32.9	-	-	5.5	9.2
C2060H/C2062H	38.10	A1/K1	28.6	-	-	-	42.9	67.8	14.7	5.5	-
	38.10	A2/K2	28.6	14.3	-	-	42.9	67.8	14.7	5.5	-
	38.10	SA1/SK1	28.6	-	17.5	19.1	32.9	-	-	5.5	9.2
	38.10	SA2/SK2	28.6	14.3	17.5	19.1	32.9	-	-	5.5	6.6
C2080/C2082	50.80	A1/K1	38.1	-	-	-	55.6	87.8	19.1	6.8	-
	50.80	A2/K2	38.1	19.1	-	-	55.6	87.8	19.1	6.8	-
	50.80	SA1/SK1	38.1	-	22.2	25.4	43.5	-	-	6.6	11
	50.80	SA2/SK2	38.1	19.1	22.2	25.4	43.5	-	-	6.6	11
C2080H/C2082H	50.80	A1/K1	38.1	-	-	-	55.6	87.8	19.1	6.8	-
	50.80	A2/K2	38.1	19.1	-	-	55.6	87.8	19.1	6.8	-
	50.80	SA1/SK1	38.1	-	22.2	25.4	43.5	-	-	6.6	11
	50.80	SA2/SK2	38.1	19.1	22.2	25.4	43.5	-	-	6.6	11
C2100/C2102	63.50	A1/K1	47.6	-	-	-	66.6	107.5	23.4	9.2	-
	63.50	A2/K2	47.6	23.8	-	-	66.6	107.5	23.4	9.2	-
	63.50	SA1/SK1	47.6	-	28.6	31.8	50.4	-	-	8.4	13
	63.50	SA2/SK2	47.6	23.8	28.6	31.8	50.4	-	-	8.4	13
C2100H/C2102H	63.50	A1/K1	47.6	-	-	-	66.6	107.5	23.4	9.2	-
	63.50	A2/K2	47.6	23.8	-	-	66.6	107.5	23.4	9.2	-
	63.50	SA1/SK1	47.6	-	28.6	31.8	50.4	-	-	8.4	13
	63.50	SA2/SK2	47.6	23.8	28.6	31.8	50.4	-	-	8.4	13

Double pitch conveyor roller chains attachment

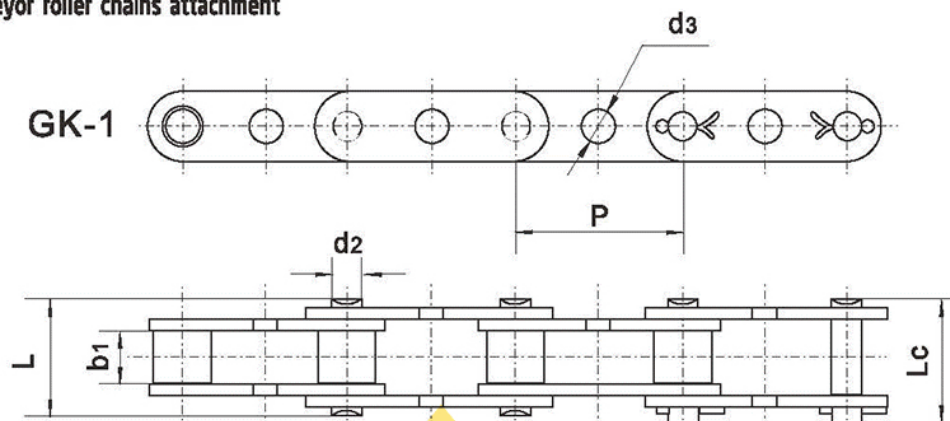

DIN/ISO Chain No.	ANSI Chain No.	P	b1	d2	d3	L	Lc
C208A	C2040	25.40	7.85	3.96	4.1	16.6	18.8
C208AL	C2042						
C210A	C2050	31.75	9.40	5.08	5.1	20.7	23.3
C210AL	C2052						
C212A	C2060	38.10	12.57	5.94	6.1	25.9	28.3
C212AL	C2062						
C212AH	C2060H	38.10	12.57	5.94	6.1	29.2	31.6
C212AHL	C2062H						
C216A	C2080	50.80	15.75	7.92	8.1	32.7	36.5
C216AL	C2082						
C216AH	C2080H	50.80	15.75	7.92	8.1	36.2	39.4
C216AHL	C2082H						
C220A	C2100	63.50	18.90	9.53	10.1	40.4	44.7
C220AL	C2102						
C220AH	C2100H	63.50	18.90	9.53	10.1	43.6	46.9
C220AHL	C2102H						

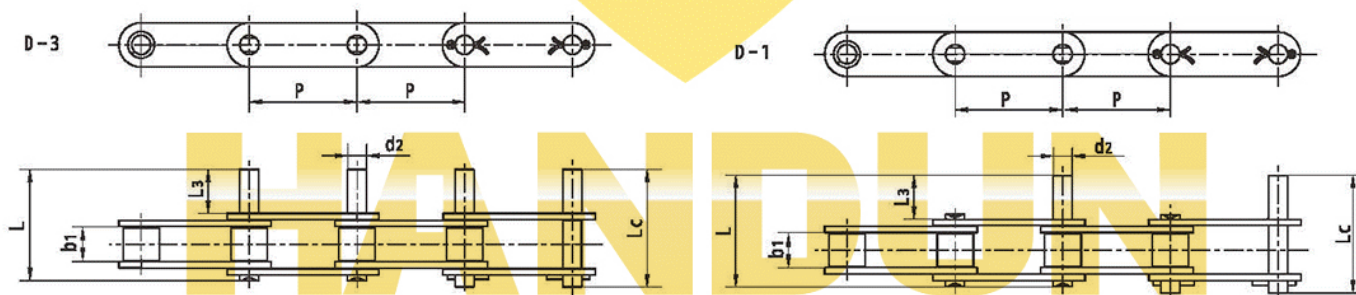

DIN/ISO Chain No.	ANSI Chain No.	P	b1	d2	L3	L	Lc
C208A	C2040	25.40	7.85	3.96	9.5	25.1	26.2
C208AL	C2042						
C210A	C2050	31.75	9.40	5.08	11.9	31.3	33.1
C210AL	C2052						
C212A	C2060	38.10	12.57	5.94	14.3	38.6	40.6
C212AL	C2062						
C212AH	C2060H	38.10	12.57	5.94	14.3	42.0	43.8
C212AHL	C2062H						
C216A	C2080	50.80	15.75	7.92	19.1	50.3	53.3
C216AL	C2082						
C216AH	C2080H	50.80	15.75	7.92	19.1	53.5	55.0
C216AHL	C2082H						
C220A	C2100	63.50	18.90	9.53	23.8	61.8	66.1
C220AL	C2102						
C220AH	C2100H	63.50	18.90	9.53	23.8	65.0	68.3
C220AHL	C2102H						
C224AH	C2120H	76.20	25.22	11.10	28.6	79.6	83.6
C224AHL	C2122						
C232AH	C2160	101.60	31.75	14.27	38.1	103.0	107.8
C232AHL	C2162						